



Specifications:

external resolution.....1/3,000
 Indicator display.....6 digits LCD
 (22mm high digits)
 operation temperature.....0°C ~ +40°C
 ADC.....sigma delta
 update rate.....≤ 0.125S
 power.....AC adapter
 (9V/800mA)
 and build-in
 rechargeable battery
 (Ni-MH, 1.2V/1200mAHx6)

Options

- RS-232 interface
- mini printer
- RS-232 interface signal cable

FEARURES

- ◆ 22mm large LCD display
- ◆ Function include change weighing unit, reading lock and change division
- ◆ Internal rechargeable with up to 40 hours of operation
- ◆ Optional RS-232 communication port, can connect to PC or printer

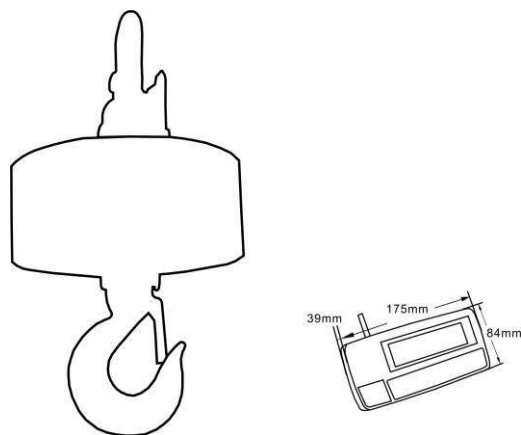

SPECIFICATIONS

Model	TR-I
Capacity	3t/5t/10t/15t
Display	22mm LCD display, attached backlight
Max. divisions	3000d
Internal counts	100,000
Keypad	6 keys
Power	rechargeable Ni-MH batteries (1.2V/1200mAhx6) AC adapter (9V/800mA)
Gross weight	0.55kg